



## Instructions for AUB Blower Kit with Cord Set



# WARNING

**RISK OF FIRE AND ELECTRICAL SHOCK!**

**TURN OFF THE GAS AND ELECTRICAL POWER BEFORE INSTALLING BLOWER!**

When installed, make sure to contain any excess wire of the cord set;  
Preventing it from making contact with moving or hot objects.

Drywall dust or other fragments may be present in your fireplace's vent space, clean this area before you install the blower kit. Any bearing or motor damage resulting from this condition is not covered by the warranty policy.

This Blower Kit is tested and safe when installed in accordance with these installation instructions. It is your responsibility to read all instructions and consult the Owner's Installation Manual for your particular model number for Supplemental Information before starting installation. Blower operates on 120V/60Hz power.

### Blower Kit Parts

Check the contents of the carton.  
Make sure nothing was damaged in shipment.  
Do NOT install a damaged blower kit!

Description	Qty.
Fan	1
Thermodisc / Heat Sensor	1
Variable Speed Control	1
Cord Set & 3-Prong Adapter	1
Velcro Strip	2
Foam Dampening Pad	1
Cable Quick Connect Ties	2
Installation Instructions (Downloadable)	1

Step 1: Turn Off Fireplace and allow it to cool down. Disconnect from 120V Power. Shut off the Gas supply.

Lay cord set out in a straight line, with the 3-Prong Power Plug furthest away from the fireplace.

Step 2: Push the green wire disconnect onto the gold ground tab on the end of fan.

Connect white and black wires of the cord set to either of the wires coming from the motor. Push disconnects together. (Figure: 1)

Step 3: Remove the screen by lifting it up and away from the fireplace. Remove the door by releasing the four latches.

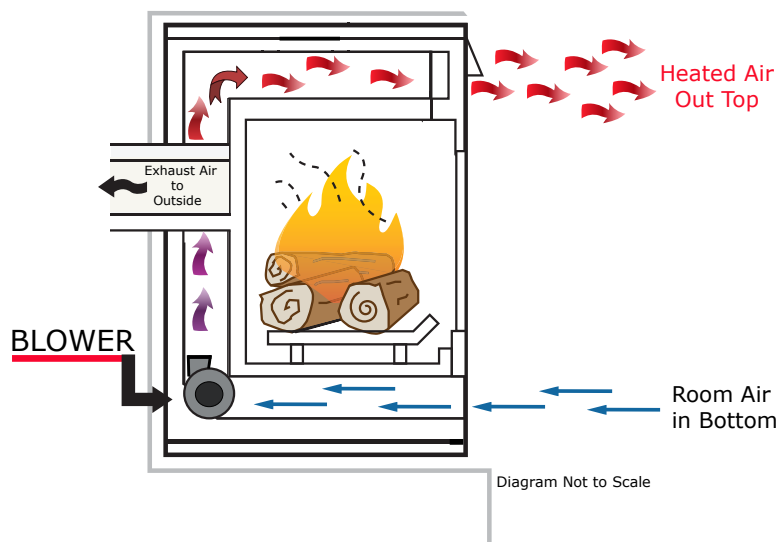



Step 4: It may be necessary to move the control module aside during blower installation. Under Firebox, wipe off the area where the Fan will be mounted, this will allow the velcro to take hold. (Figures: 1 & 2) Visualize a pathway for the blower to reach the side wall. Remove the clear backing of the velcro strips. (Figure: 3)

Position blower assembly against the side wall, so the blower's rectangle air exit port is facing up. Hold against wall for 5-10 seconds for the adhesive padding strips to take hold. The dampening pad on the underside of the blower will rest on the floorpan. (Figure: 1 & 2)

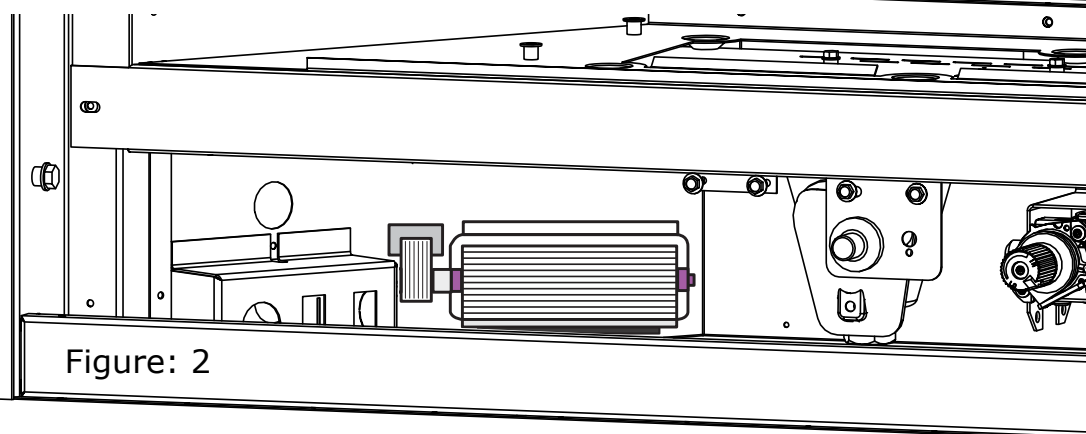
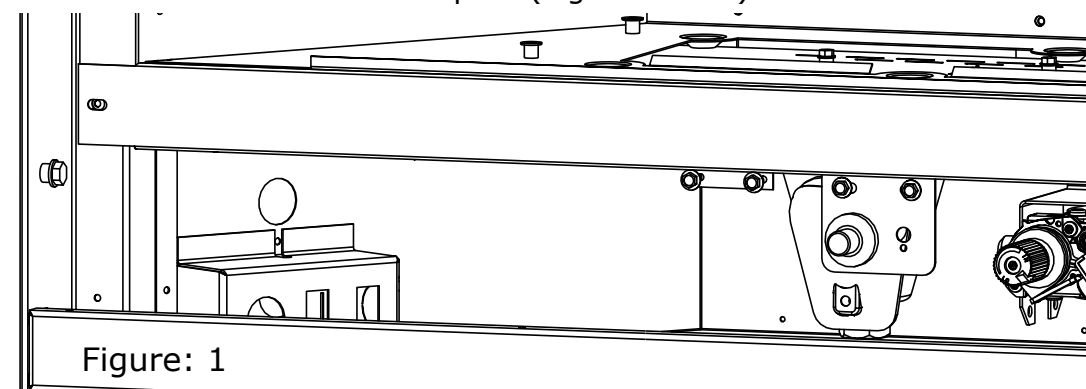

Step 4: Place magnetic thermodisc 2 inches to the Left of the Red Ignitor Assembly and 3 inches toward the back of the firebox to the underside of the firebox. The silver disc must have flush contact with the metal. (Figure: 3)

The thermodisc will activate the blower when it senses 120°F and will automatically turn the blower off after the fireplace cools below 90°F.

Step 5: The Variable Speed Control may simply be set on the floor of the lower vent space near the front. A Velcro Strip is attached to the speed control for mounting on the side wall. Turn the dial to the left and it will click off, turn right to reduce speed. (Figure: 3)

- Use the supplied cable ties to channel and hold wire away from the blower wheel.
- Place the control module back into its original position. Ensure the transformer is plugged into the junction box.
- Plug power cord from the blower into the electrical box. Use 3-Prong to 2-Prong adapter if necessary.



The fan will not run until the Thermodisc / Heat Sensor reaches approximately 120°F and the Variable Speed Control is turn to the "ON" Position! This means the Heat Sensor must be in contact with a hot spot on the underside of the Firebox.

